

序号/RevNo.	名称/Title	文件编号/File No.
1	114单排塑料件	QJ/XYT-11124
2	114端子图(直)	QJ/XYT-11128

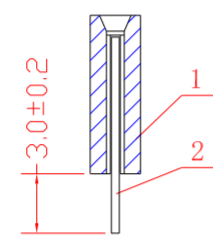
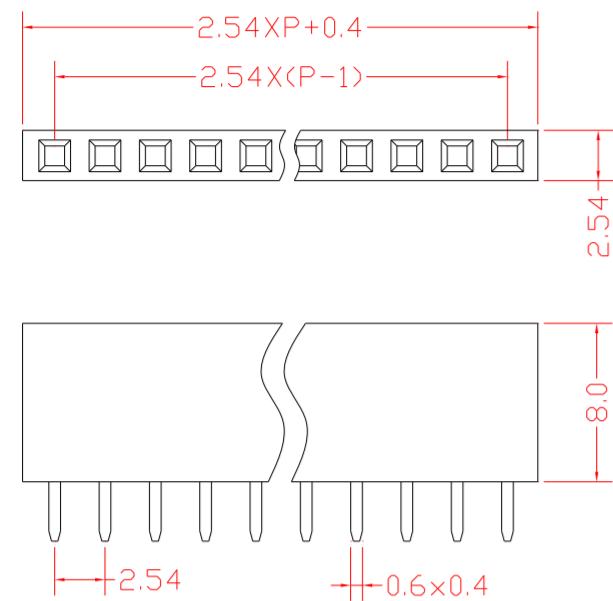

Specifications:
 Contact Resistance: 30mΩ max.at DC 100 mA
 Insulator Resistance: 1000MΩ min.at DC 500V
 Current Rating: 1AMP

Dielectric Withstanding
 Voltage: AC 500V For 1 minute
 Operating Temperature:-55°C--+105°C
 Contact: Brass
 Housing: PBT &30% Glass Fiber(UL 94V-0)

- 要求:
1. 塑料件无裂痕。
 2. 整排端子成一直线，相邻端子之间相互平行。

设计/Designed by	绘图/Drawing by	审核/Checked by	批准/Approved by	未注公差 General Tolerance
				X. ±0.2 X.' ±2' .X ±0.1 .X' ±1' .XX ±0.05 .XX' ±0.5 .XXX ±0.01
图名/Title		文件编号/File No.		
114-A单排直针 产品图		QJ/XYT-12034		
页序/Sheet		页序/Sheet		
备注/Remark		单位/Units: mm		

序号/RevNo. 更改记录/Revision note 签名/Signature 日期/Date

序号/RevNo.	名称/Title	文件编号/File No.
1	114双排塑料件	QJ/XYT-11125
2	114端子图(直)	QJ/XYT-11128

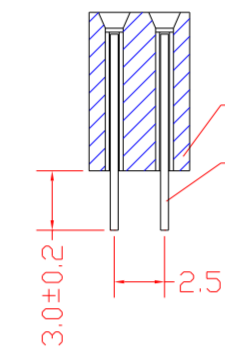
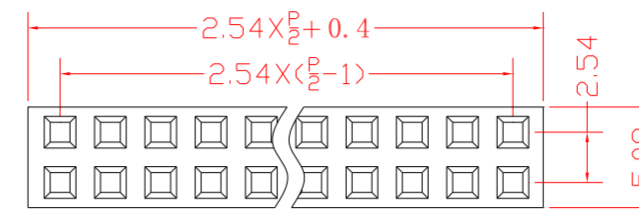

Specifications:
 Contact Resistance: 30mΩ max.at DC 100 mA
 Insulator Resistance: 1000MΩ min.at DC 500V
 Current Rating: 1AMP

Dielectric Withstanding
 Voltage: AC 500V For 1 minute
 Operating Temperature:-55°C--+105°C
 Contact: Brass
 Housing: PBT &30% Glass Fiber(UL 94V-0)

- 要求:
1. 塑料件无裂痕。
 2. 整排针成一直线，相邻针之间相互平行。

设计/Designed by	绘图/Drawing by	审核/Checked by	批准/Approved by	未注公差 General Tolerance
				X. ±0.2 X.' ±2' .X ±0.1 .X' ±1' .XX ±0.05 .XX' ±0.5 .XXX ±0.01
图名/Title		文件编号/File No.		
114-A双排直针 产品图		QJ/XYT-12035		
页序/Sheet		页序/Sheet		
备注/Remark		单位/Units: mm		

序号/RevNo. 更改记录/Revision note 签名/Signature 日期/Date

序号/RevNo.	名称/Title	文件编号/File No.
1	114单排塑料件	QJ/XYT-11124
2	114端子(短弯)	QJ/XYT-11126

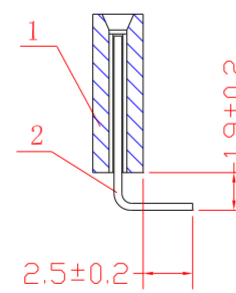
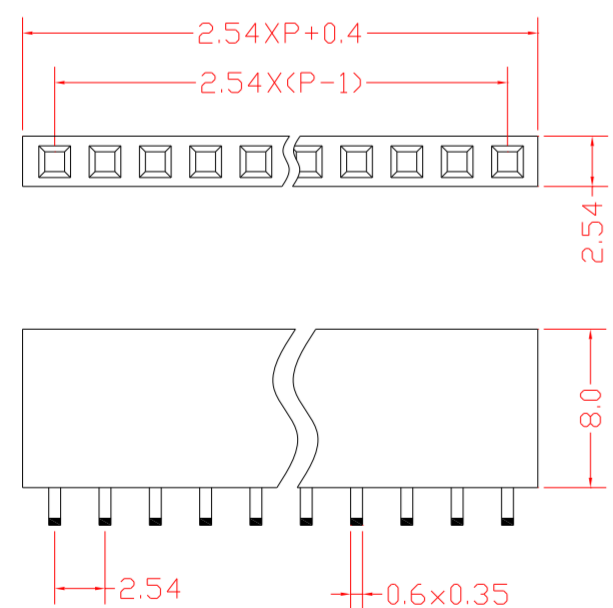

Specifications:
 Contact Resistance: 30mΩ max.at DC 100 mA
 Insulator Resistance: 1000MΩ min.at DC 500V
 Current Rating: 1AMP

Dielectric Withstanding
 Voltage: AC 500V For 1 minute
 Operating Temperature:-55°C--+105°C
 Contact: Brass
 Housing: PBT &30% Glass Fiber(UL 94V-0)

- 要求:
1. 塑料件无裂痕。
 2. 整排端子成一直线，相邻端子之间相互平行。

设计/Designed by	绘图/Drawing by	审核/Checked by	批准/Approved by	未注公差 General Tolerance
				X. ±0.2 X.' ±2' .X ±0.1 .X' ±1' .XX ±0.05 .XX' ±0.5 .XXX ±0.01
图名/Title		文件编号/File No.		
114-A单排弯针 产品图		QJ/XYT-12036		
页序/Sheet		页序/Sheet		
备注/Remark		单位/Units: mm		

序号/RevNo. 更改记录/Revision note 签名/Signature 日期/Date

序号/RevNo.	名称/Title	文件编号/File No.
1	114双排塑料件	QJ/XYT-11125
2	114端子(短弯)	QJ/XYT-11126
3	114端子(长弯)	QJ/XYT-11127

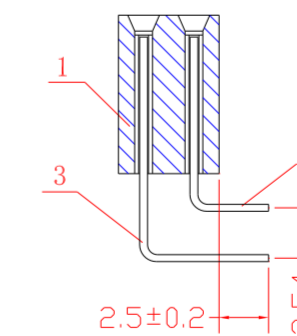
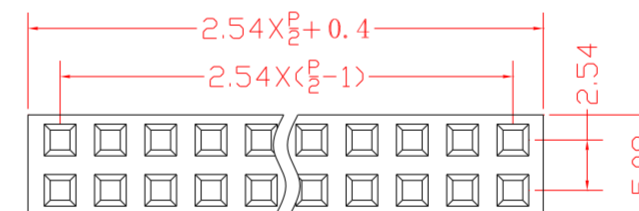

Specifications:
 Contact Resistance: 30mΩ max.at DC 100 mA
 Insulator Resistance: 1000MΩ min.at DC 500V
 Current Rating: 1AMP

Dielectric Withstanding
 Voltage: AC 500V For 1 minute
 Operating Temperature:-55°C--+105°C
 Contact: Brass
 Housing: PBT &30% Glass Fiber(UL 94V-0)

- 要求:
1. 塑料件无裂痕。
 2. 整排针成一直线，相邻针之间相互平行。

设计/Designed by	绘图/Drawing by	审核/Checked by	批准/Approved by	未注公差 General Tolerance
				X. ±0.2 X.' ±2' .X ±0.1 .X' ±1' .XX ±0.05 .XX' ±0.5 .XXX ±0.01
图名/Title		文件编号/File No.		
114-A双排弯针 产品图		QJ/XYT-12037		
页序/Sheet		页序/Sheet		
备注/Remark		单位/Units: mm		

序号/RevNo. 更改记录/Revision note 签名/Signature 日期/Date