

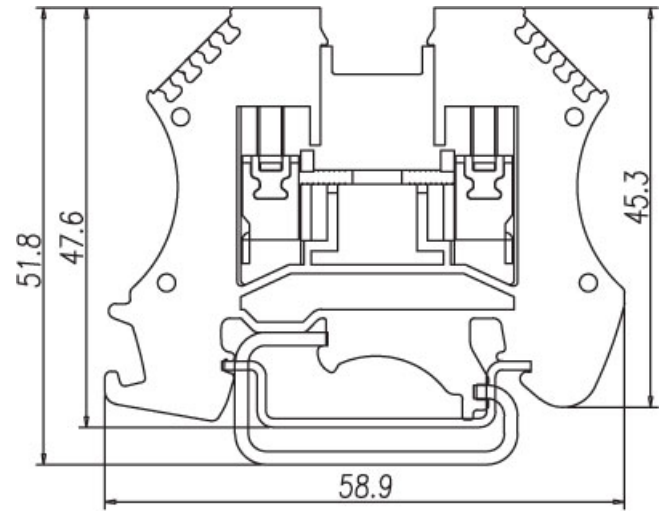

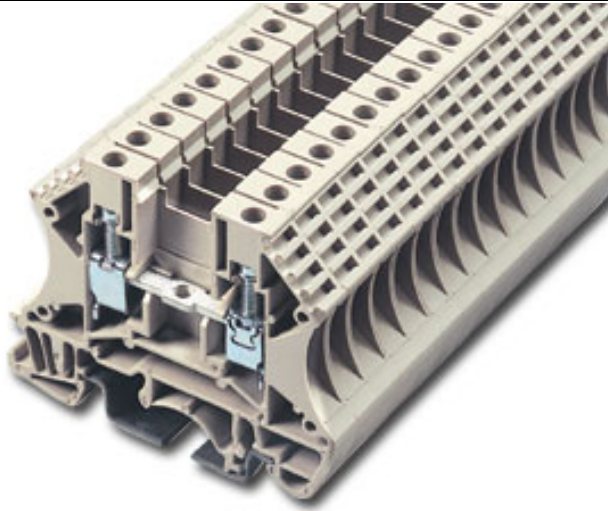



DIN Rail terminal blocks / DK series



DK4



Approval	 	
Technical Data	UL	IEC
Rated voltage	600V	630V
Rated current	35A	32A
Conductor cross-section, solid (AWG / mm ²)	22~10 / 0.34~4	
Conductor cross-section, flexible (AWG / mm ²)	22~10 / 0.34~4	
Rated impulse withstand voltage	8KV	
Torque (N-m)	0.5	
Screw	M3	
Wire strip length	10~12mm	
Insulating material	PA	
TxHxW (mm)	6.1 x 46.85 x 58.9	
Optional color	Cat. No.	
	DK4-RD	
	DK4-BL	
	DK4-BK	
	DK4-OR	



	Accessories	Cat. No.
End cover		DK2.5C
Partition		DKSPS-002
Small partition		DKSPS-001
Insertion bridge		
Insertion bridge	2 way	CSC-402P
	:	:
	:	:
	10 way	CSC-410P
Screw-on bridge	2 way	DS4-02P
	:	:
	:	:
	10 way	DS4-10P
Marking label		TM27
Mounting Rail		TS-35 / TS-32
Tool		0.5 x 3mm